



Google Chrome & Firefox Password Managers



Introduction

It is very important that passwords are stored in secure locations. 80% of data breaches happen do due to poor password management and/or weak passwords.

Passwords should never be stored in the following formats:

- Windows Desktop Sticky Notes
- Notepad document
- Unprotected Excel Spreadsheet
- Word Document

Saving your passwords in these formats puts both you and the company at risk. One of the safest and most secure places to store your passwords is in your browser's password manager. Browser password managers encrypt passwords making them unreadable unless you know the password to access it, this means if the worst happened and your computer was compromised, the passwords would be safely locked away from the threat actor.

The guide below will take you through how to use Google Chrome and Firefox's password managers. In this guide you will learn how to use the password manager to store passwords safely and securely. This guide will also show you how to view your passwords, edit or remove passwords.

Google Chrome

To access your Chrome password manager, click on the ellipsis in the top right corner of your browser.

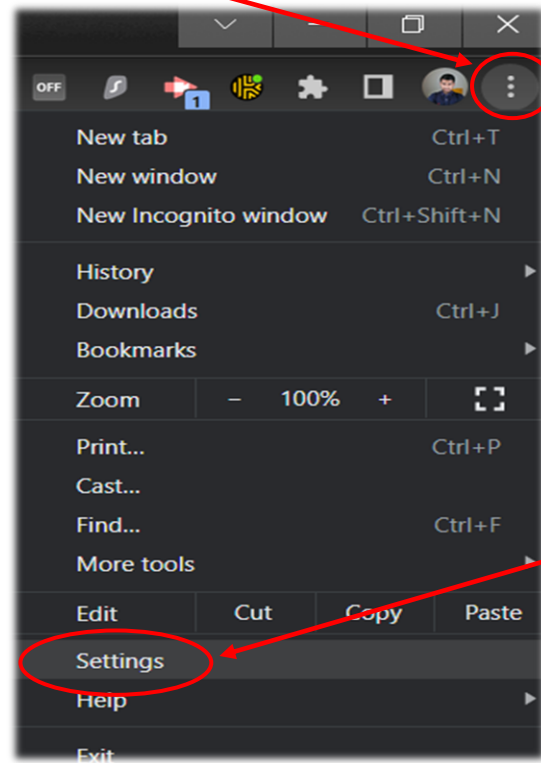

This opens a drop-down menu, from here click on settings.

On the Settings page,
select **Auto-Fill**.

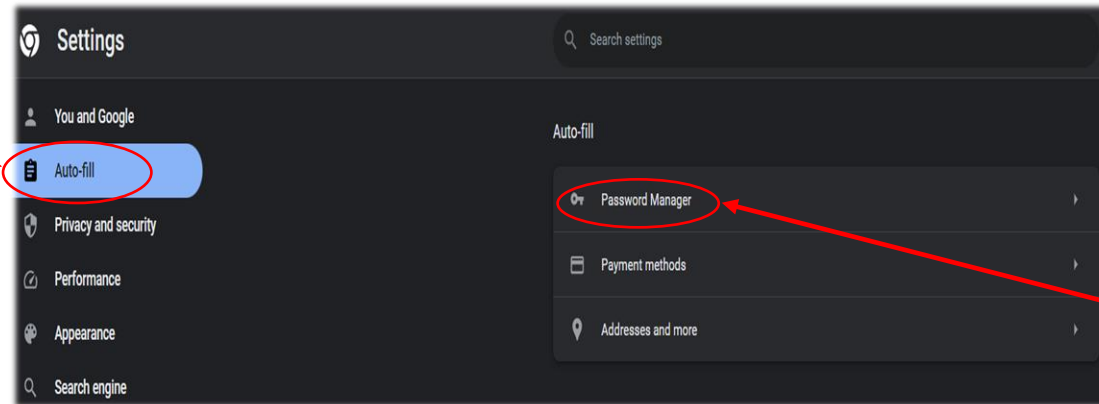

Next click on **Password Manager**.

You are now on the
password manager page,
from here you can add, edit
or remove passwords.

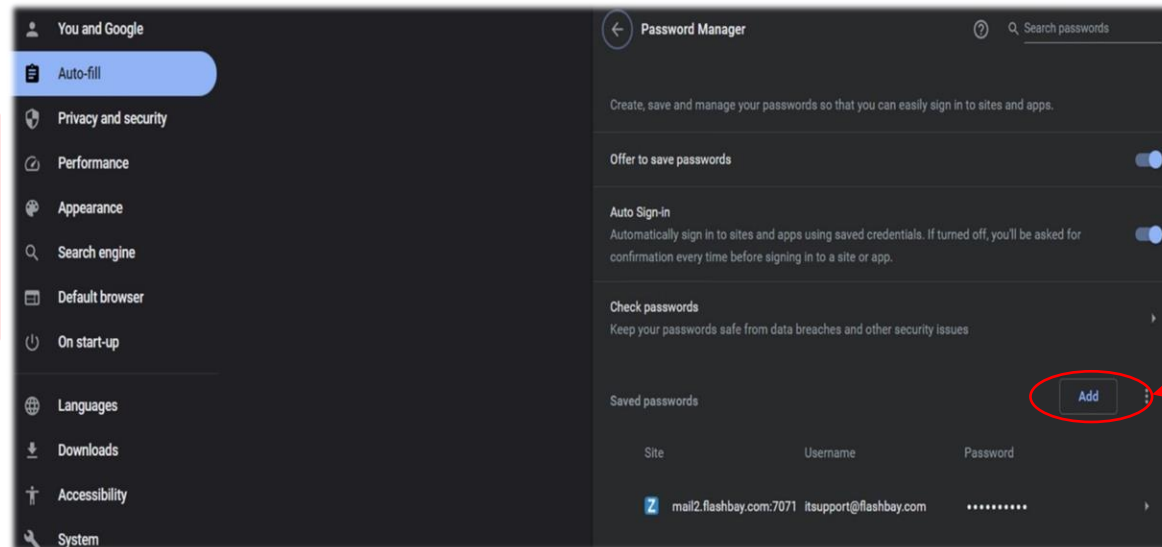

Click **Add** to add a
password.

From here you can store a new passwords. You can copy the website URL, then type in your **username** and **password**. Once you click on **Save**, this entry will now be stored. This means whenever you visit that website the password will autofill.

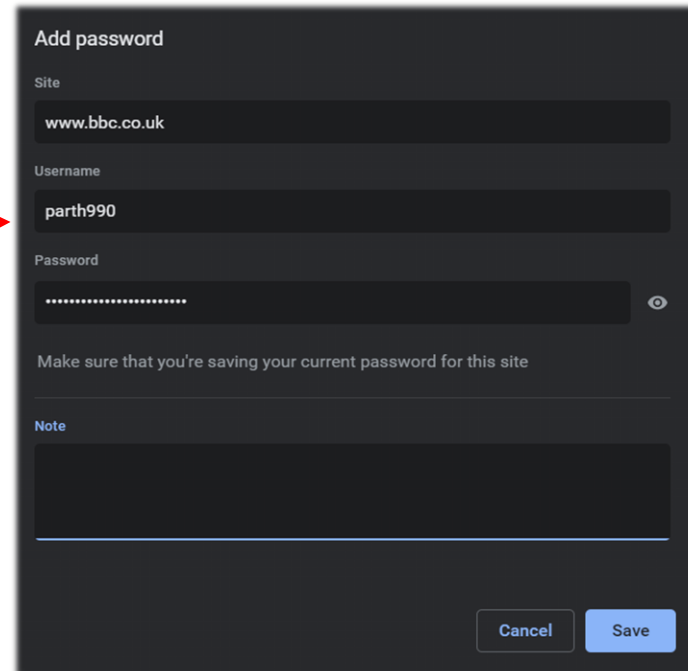

Add password

Site
www.bbc.co.uk

Username
parth990

Password
.....

Make sure that you're saving your current password for this site

Note

Cancel Save

Once you have an entry saved, you can edit it (In case you need to update the password) by clicking on the **Edit** option.

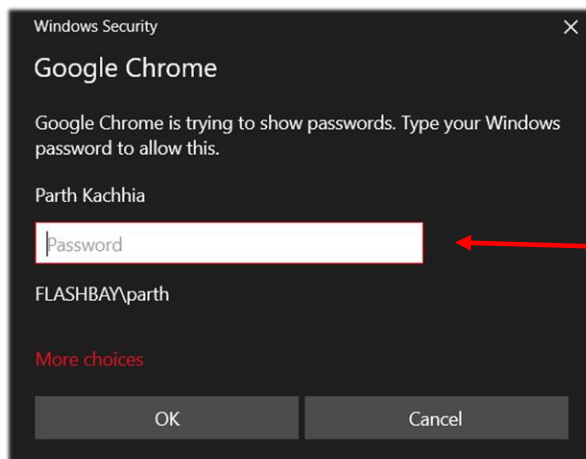
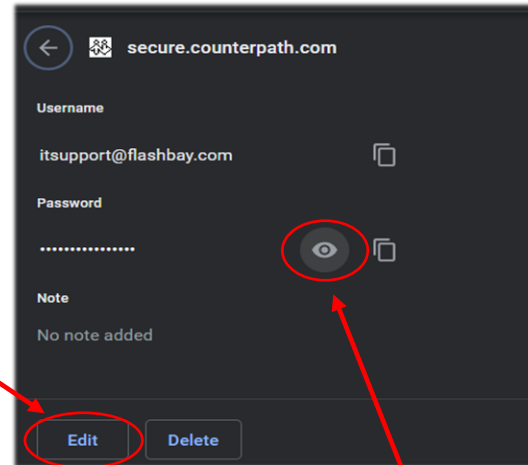

You can also view the password by clicking on the small **eye icon**. If you click on this to view the password, you will be asked for your **Windows username and password**, once entered your password will become visible.

To access your FireFox password manager, click on the ellipsis in the top right corner of your browser.

This opens a drop-down menu, from here click on **passwords**.

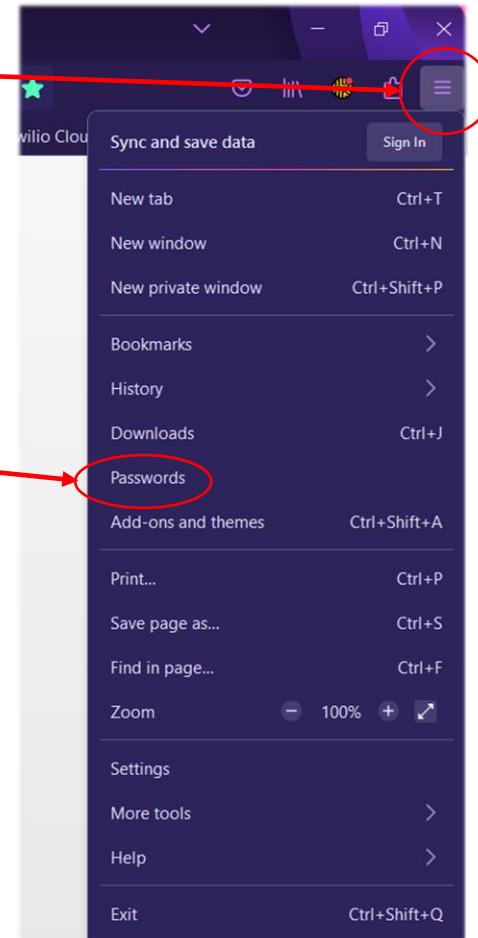

Again, very similar to chrome, once you click on the **plus sign**, you will be able to create a new entry here.

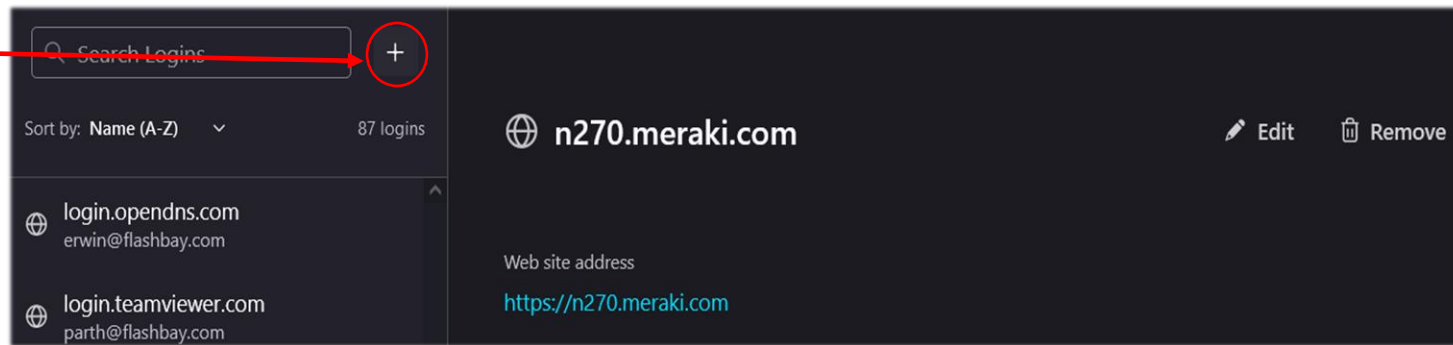

Search Logins +

Sort by: Name (A-Z) 87 logins

- login.opendns.com
erwin@flashbay.com
- login.teamviewer.com
parth@flashbay.com

n270.meraki.com Edit Remove

Web site address
<https://n270.meraki.com>

Once the **plus sign** is clicked, this form will pop up. Here, you can edit the URL, username, and password of the entry you would like to save. The entry will autofill every time you login.

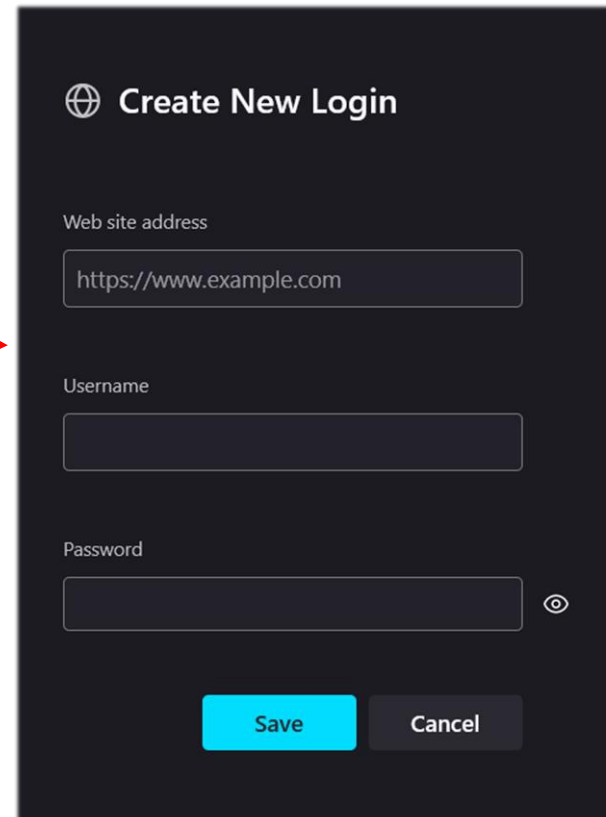

 Create New Login

Web site address

Username

Password
 

Also, on the **passwords** page very similar to Chrome, you can click on the **eye icon** to view your saved password.

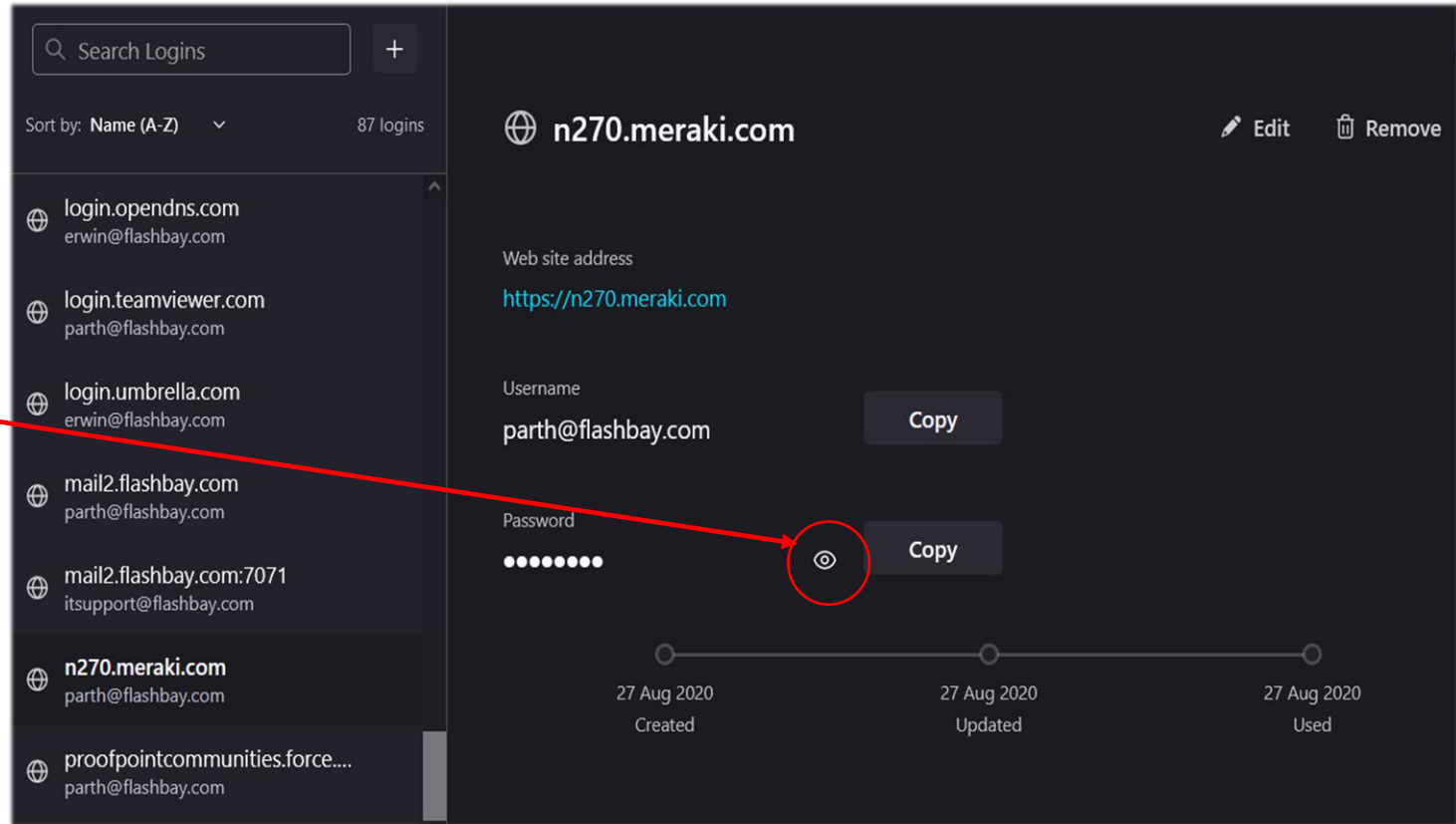

The screenshot displays the Flashbay interface for managing passwords. On the left, a list of logins is shown, sorted by name (A-Z), with 87 total logins. The selected login is **n270.meraki.com** with the email **parth@flashbay.com**. The right pane shows details for this login, including the web site address (<https://n270.meraki.com>), the username (**parth@flashbay.com**), and the password (represented by dots). A red circle highlights the eye icon next to the password field, which is used to toggle password visibility. Below the password field, a timeline shows the login was created and updated on 27 Aug 2020, and used on 27 Aug 2020. The interface includes search, sort, and edit/remove options.



Password Generator

To help create strong passwords, we have created a password generator for you to use. It can be found on your desktop, (Please see below).

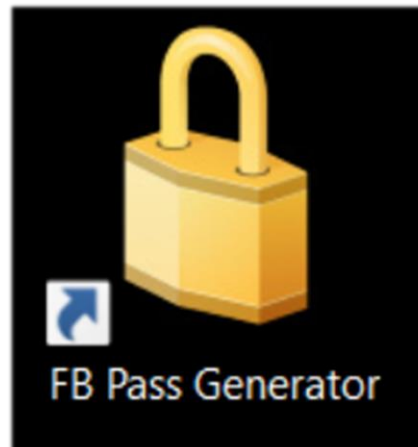

Once you open the password generator, you will see this popup. From here, you can choose the length of the password and how many passwords you would like to generate. Please ensure your password is at least **10 characters**.

Once generated, these passwords can be easily copied and pasted.

